

PARK HYATT SHANGHAI is the city’s leading ultra–luxury hotel, and the first to bring sophistication to Shanghai by occupying the 79th and 93rd floors of the Shanghai World Financial Centre (SWFC), otherwise known as “The Vertical Complex City”, in the heart of the Lujiazui business district in Pudong, Shanghai. The 492 m (1,614 ft) SWFC, with its 101 storeys, is one of the tallest buildings in the world.



ACCOMODATION

- 174 guestrooms including 14 suites
- Guestrooms feature day–beds for in–room pampering and wellness treatment
- Bathrooms feature a flat screen TV embedded into the vanity mirror, double sinks, an Oriental bathing area, an oversized rain shower, a deep–soaking bath, heated floors and a separate powder room
- Walk–in dressing room
- Personal safe suitable for laptop
- Fully stocked private bar
- High speed Internet connectivity
- Non–smoking floors available

SERVICES AND FACILITIES

- Lobby on the 87th Floor
- 24–hour butler service and in–room dining
- Technology concierge
- Laundry and dry–cleaning service
- Twice daily housekeeping service
- Airport limousine service
- Manager on duty 24 hours
- Major credit cards accepted
- Multilingual hotel staff

RESTAURANTS AND BARS

On the 87th floor:

- Living Room serves simple yet sophisticated Chinese and Western light dishes. Famous for afternoon tea and Champagne at sunset with a stunning view
- Pantry serves casual all day dining and a la minute buffet in the evening
- Dining Room features formal European provincial cuisines in an elegant setting with signature wine pairing menus
- Bar is an exclusive Champagne venue with geography lesson from the window through collection of antique telescopes

On the 91st, 92nd and 93rd floors, 100 Century Avenue, one of its kind dining, entertainment and meeting destination offers the ultimate wining and dining experience in Shanghai:

- The 91st floor is the restaurant with multiple show kitchens, featuring steakhouse, Chinese wok, steamed specialties, Japanese sushi, all served from one menu and a wine cellar with over 800 wine labels
- The 92nd floor showcases two bars – Music

Room is the highest nightclub in the world featuring live music performance, resident DJ and special theme parties; and the sophisticated Shanghai Lounge with crimson red interior and romantic setting

- The 93rd floor is the highest venue for private dining and events in the world, serving Western, Chinese and Japanese cuisines

RECREATIONAL FACILITIES

Water’s Edge on the 85th floor:

- Spa and Wellness studio
- Infinity pool and whirlpool spa
- Steam room
- Tai Chi courtyard

MEETING FACILITIES

- The Salons on the 86th floor with seven private dining and meeting rooms can accommodate exclusive board meetings of eight guests, up to 96 guests for dinner or cocktail parities for up to 100 guests

- 100 Century Avenue function spaces on the 93rd floor featuring three exclusive private dining rooms, can provide board meetings of 22 guests, up to dinner events for 180 guests or cocktails for up to 200 guests
- High speed broadband Internet access in all meeting rooms
- Wireless LAN available in all public areas and meeting rooms
- All meeting rooms equipped with built–in LCD projector, screen and flat screen television
- Tele–conferencing facilities

VISITOR INFORMATION

- Climate: Average temperatures vary from 6C/43F in January to 30C/86F in August
- Language: Mandarin
- Electricity: 220 volts AC
- Currency: Renminbi (CNY)
- Please confirm visa requirements with your local embassy or travel planner



TRANSPORTATION

FROM	DISTANCE	TIME	BY
Hongqiao Intl. Airport	25 KM.	30 MIN.	CAR
Pudong Intl. Airport	40 KM.	45 MIN.	CAR
Railway Station	12 KM.	30 MIN.	CAR

POINTS OF INTEREST

- Observatory on the 100th floor of Shanghai World Financial Centre to enjoy a panoramic view over the city
- The Bund, the famous historic waterfront with a wide range of turn–of–the–century architecture known as “an international architectural exhibition”
- Yu Garden and the Wen Temple are located in one of the oldest parts of Shanghai and a great sample of pre–colonial Shanghai. The Yu Garden Bazaar is a perfect place to purchase souvenirs
- Shanghai Museum, Shanghai Art Museum, MoCA Shanghai, Urban Planning Exhibition Hall located around the People’s Square area, offers a one–stop experience of Shanghai’s cultural, history and future
- M50 Art Zone along the Suzhou Creek features contemporary Chinese and international art galleries, designer boutiques and cafes in old industrial warehouse settings
- Riverside Boulevard, Pudong’s answer to the Bund: this strip of green along the east bank of the Huangpu River, offers a fine view of the Bund at a distance



上海柏悅酒店
PARK HYATT SHANGHAI

100 Century Avenue, Pudong New Area, Shanghai, China 200120
TELEPHONE +86 21 6888 1234 FACSIMILE +86 21 6888 3400
parkhyattshanghai.com

The trademark HYATT and related marks are trademarks of Hyatt International Corporation
©2010 Hyatt International Corporation. All rights reserved



上海柏悅酒店
PARK HYATT SHANGHAI

FLOOR PLANS

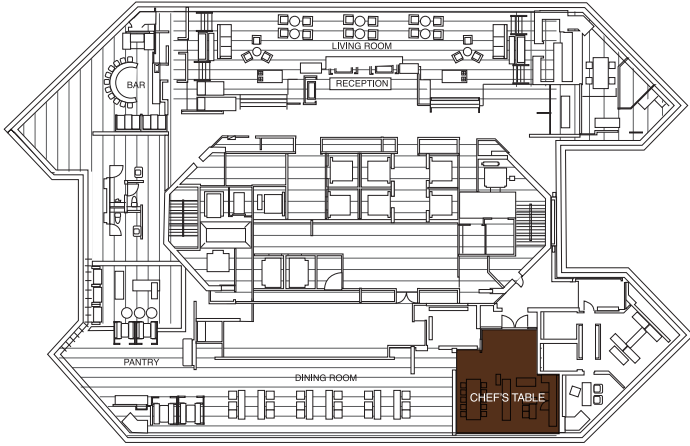

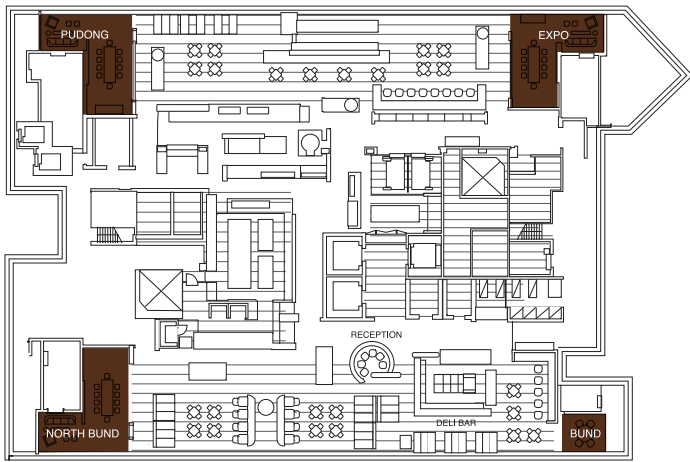

87TH FLOOR



91ST FLOOR

ROOM DIMENSIONS AND CAPACITIES

ROOM	AREA M ² FT ²	 DINING	 COCKTAIL
Private Dining Room on 87th Floor			
Chef's Table	83 893	20	40
Private Dining Room on 91st Floor			
Bund (Semi Private)	12 129	6	—
North Bund	43 462	16	—
Expo	37 398	10	—
Pudong	42 452	14	—

SHANGHAI WORLD FINANCIAL CENTER

492M
1614FT

IOIF

- 93F Private Dining
- 92F Music Room & Shanghai Lounge
- 91F 100 Century Avenue

- 88F Suites
- 87F Lobby, Dining Room, Pantry, Living Room & Bar
- 86F Salons
- 85F Water's Edge
- 79-84F Guestrooms

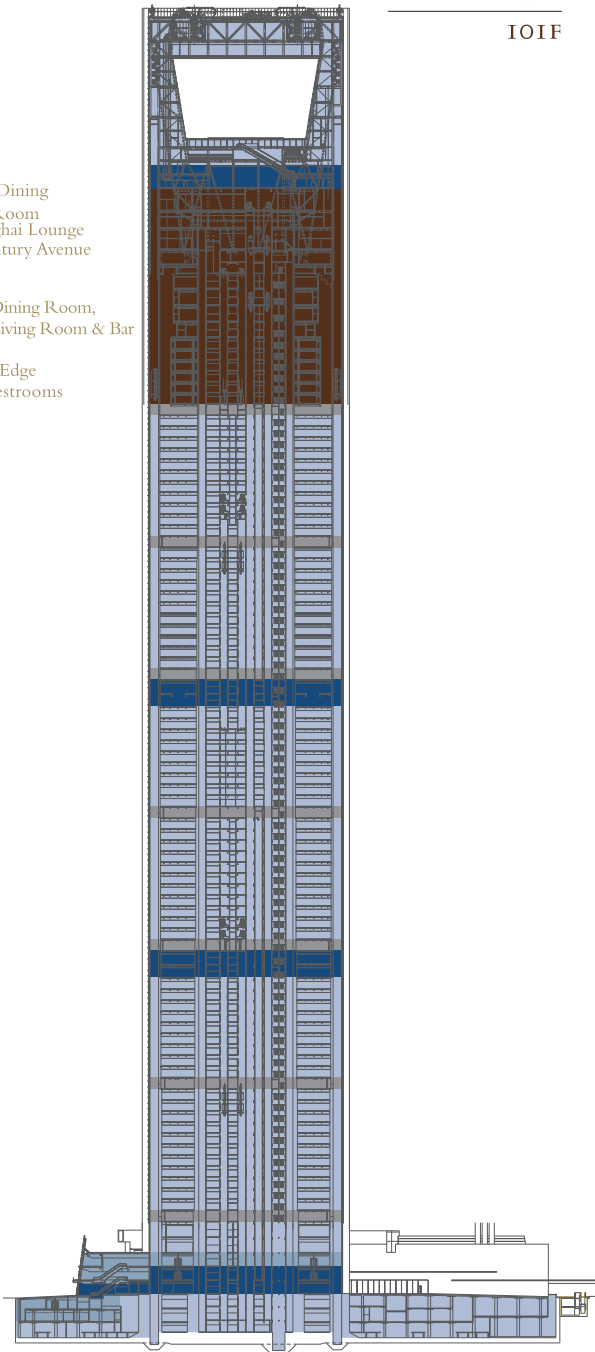

97-100F
Observatory

94F
Sky Arena

79-93F

上海柏悅酒店

PARK HYATT SHANGHAI







55-77F
Office

52-53F
Sky Lobby
31-51F
Office

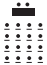
28-29F
Sky Lobby
7-27F
Office
3-5F
Conference Center
B2-3F
Shopping Mall

1-2F
Entrance
B3-B1F
Parking

ROOM DIMENSIONS AND CAPACITIES

ROOM	DIMENSIONS M/FT L X W X H	AREA M ² FT ²	 THEATRE STYLE	 CLASSROOM	 U-SHAPED	 BOARD ROOM	 BANQUET	 COCKTAIL
Salons on 86th Floor								
Salon I	10 X 9 X 4 33 X 30 X 13	90 969	-	-	-	-	14	-
Salon II	10 X 9 X 4 33 X 30 X 13	90 969	-	-	-	-	14	-
Salon III	19 X 9 X 4 62 X 30 X 13	171 1841	100	81	-	-	96	98
Salon IV	12 X 6.2 X 4 39 X 20 X 13	74 797	-	-	-	14	-	-
Salon V	12 X 6.2 X 4 39 X 20 X 13	74 797	-	-	-	14	-	-
Salon VI	19 X 9 X 4 62 X 30 X 13	171 1841	100	81	-	-	96	98
Salon VII	10 X 9 X 4 33 X 30 X 13	90 969	-	-	-	-	14	-
Private Dining on 93rd Floor								
North House	12 X 6.3 X 5.1 39 X 21 X 16.7	76 818	38	18	20	22	22	48
South House	12 X 6.3 X 5.1 39 X 21 X 16.7	76 818	38	18	20	22	22	48
North & South House	20 X 12 X 5.1 66 X 39 X 16.7	240 2583	182	120	48	-	180	148
West House	10 X 6.6 X 5.1 33 X 22 X 16.7	66 710	-	-	-	-	18	24
All function spaces	30 X 20 X 5.1 98 X 66 X 16.7	600 6459	-	-	-	-	-	228
Sky Arena on 94th Floor								
Sky Arena	27 X 28 X 8 88 X 91 X 26	760 8180	-	-	-	-	300	450

FLOOR PLANS

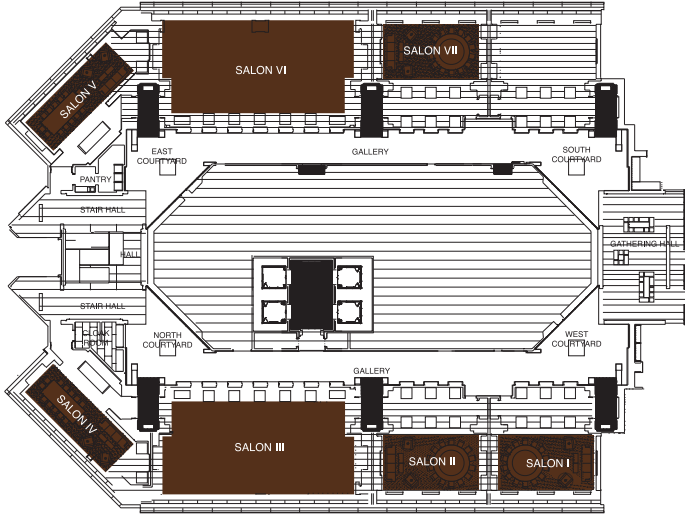

86TH FLOOR

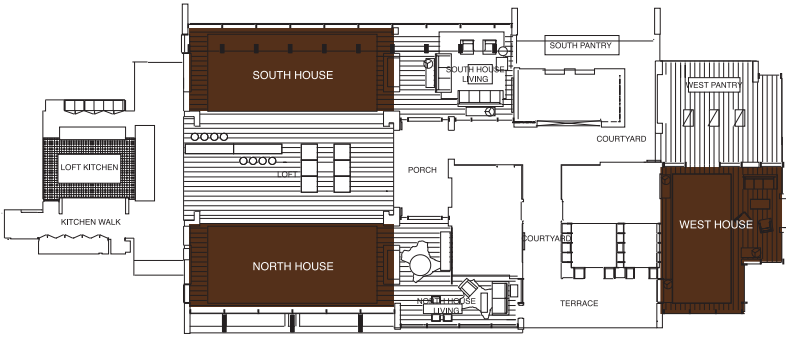

93RD FLOOR



94TH FLOOR